



ADVENTURE  
IS OUT THERE



#stelvio #tirreno #unico #aqua



A cyclist wearing a teal and black long-sleeved jersey, black shorts, a white helmet, and sunglasses is riding a blue road bike on a winding asphalt road. The road curves to the right, marked with yellow lines. In the background, there are steep, green mountains under a cloudy sky. A concrete guardrail with black and white diagonal stripes runs along the edge of the road. A yellow arrow sign points to the right. The text "Welcome to Roger de Vlaeminck" is overlaid in the top right corner.

# Welcome to Roger de Vlaeminck

Roger lets you create your dream bike with the **#buildyourroger** system.

Build your custom bike just the way you want it, & then ride with pride.



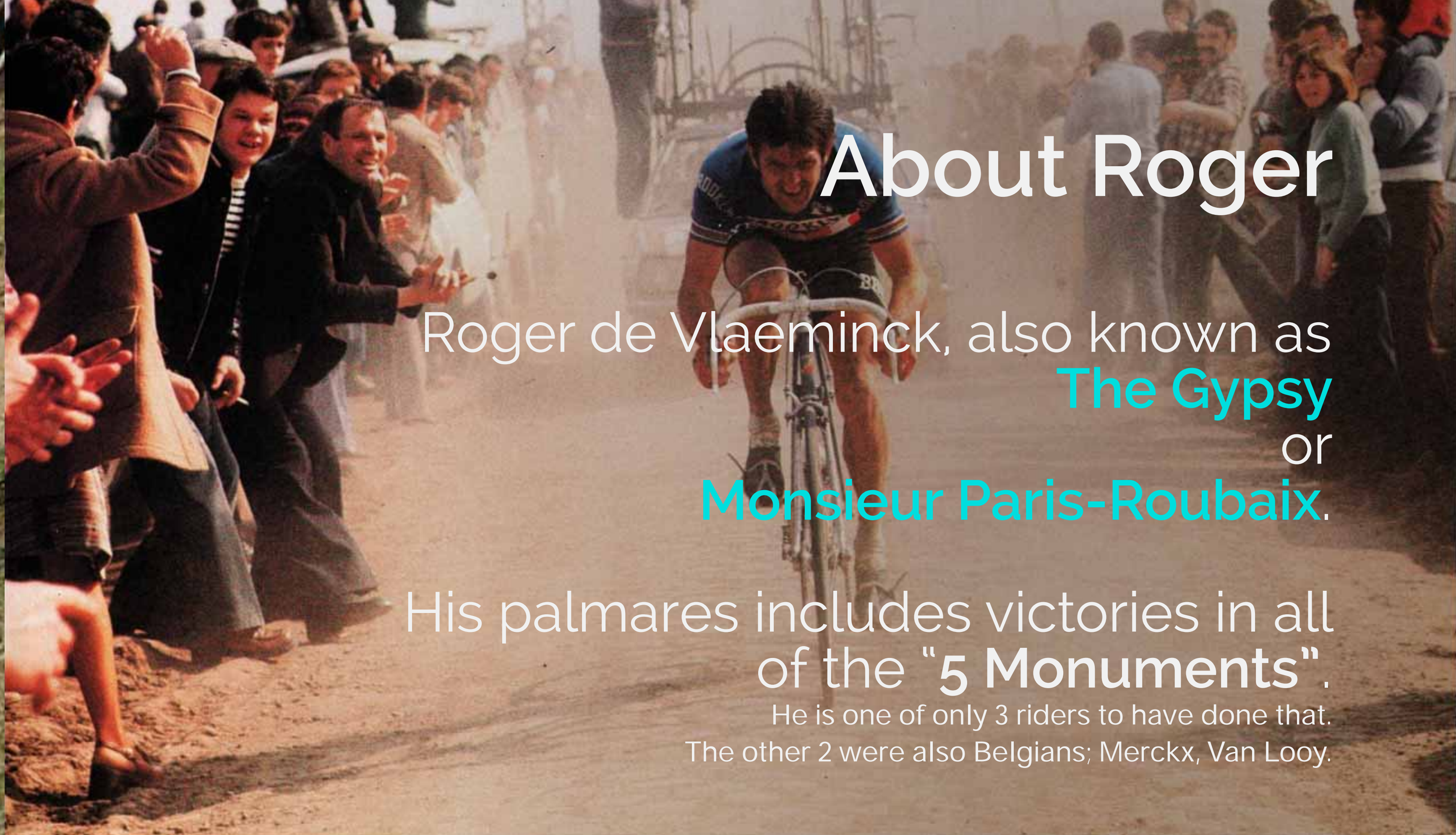

# About Roger

Roger de Vlaeminck, also known as  
**The Gypsy**  
or  
**Monsieur Paris-Roubaix.**

His palmares includes victories in all  
of the "5 Monuments".

He is one of only 3 riders to have done that.  
The other 2 were also Belgians; Merckx, Van Looy.

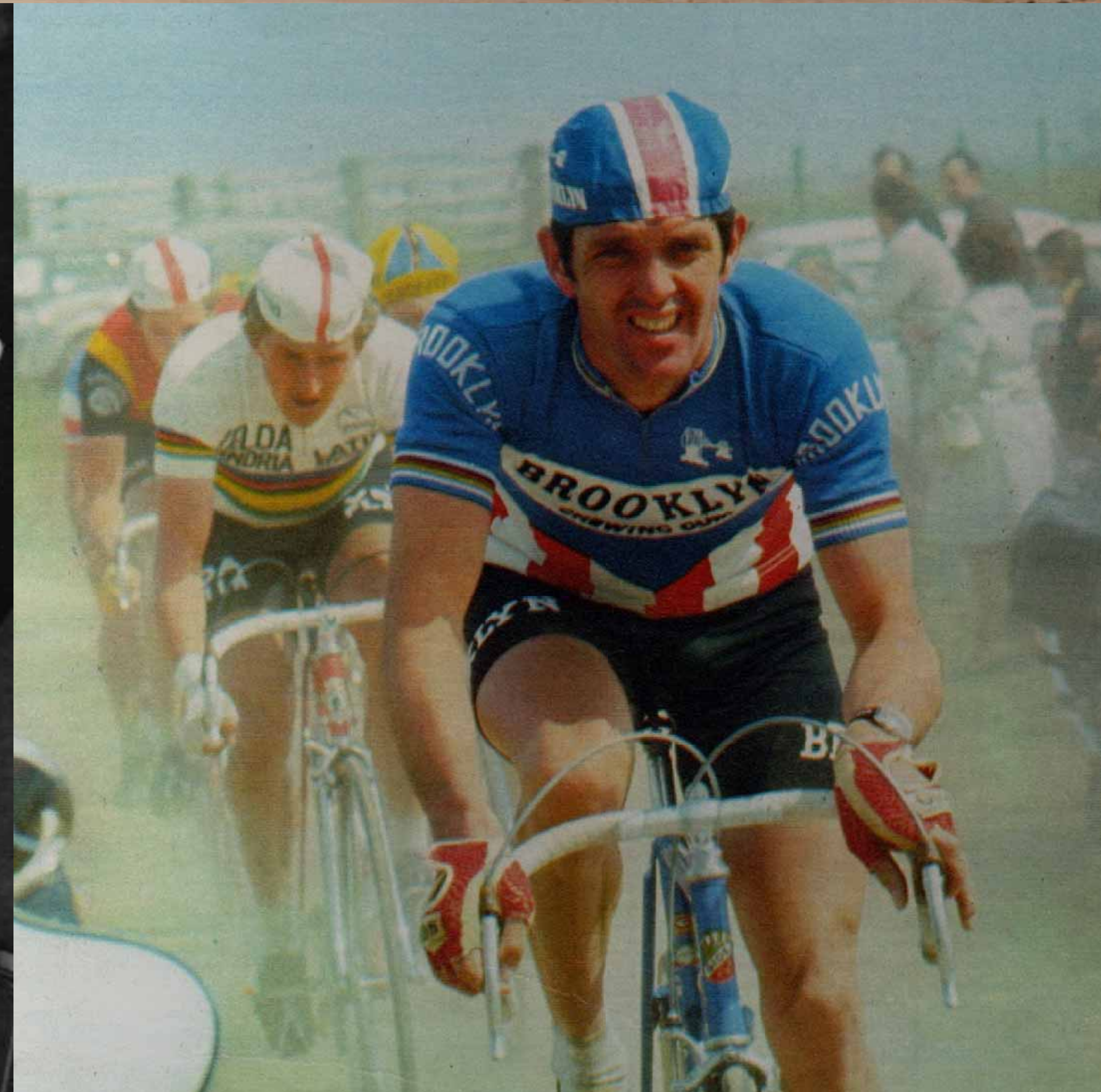



# Roger's Philosophy

Roger wants your dream bike to become reality.

Therefore we sell directly to the rider.

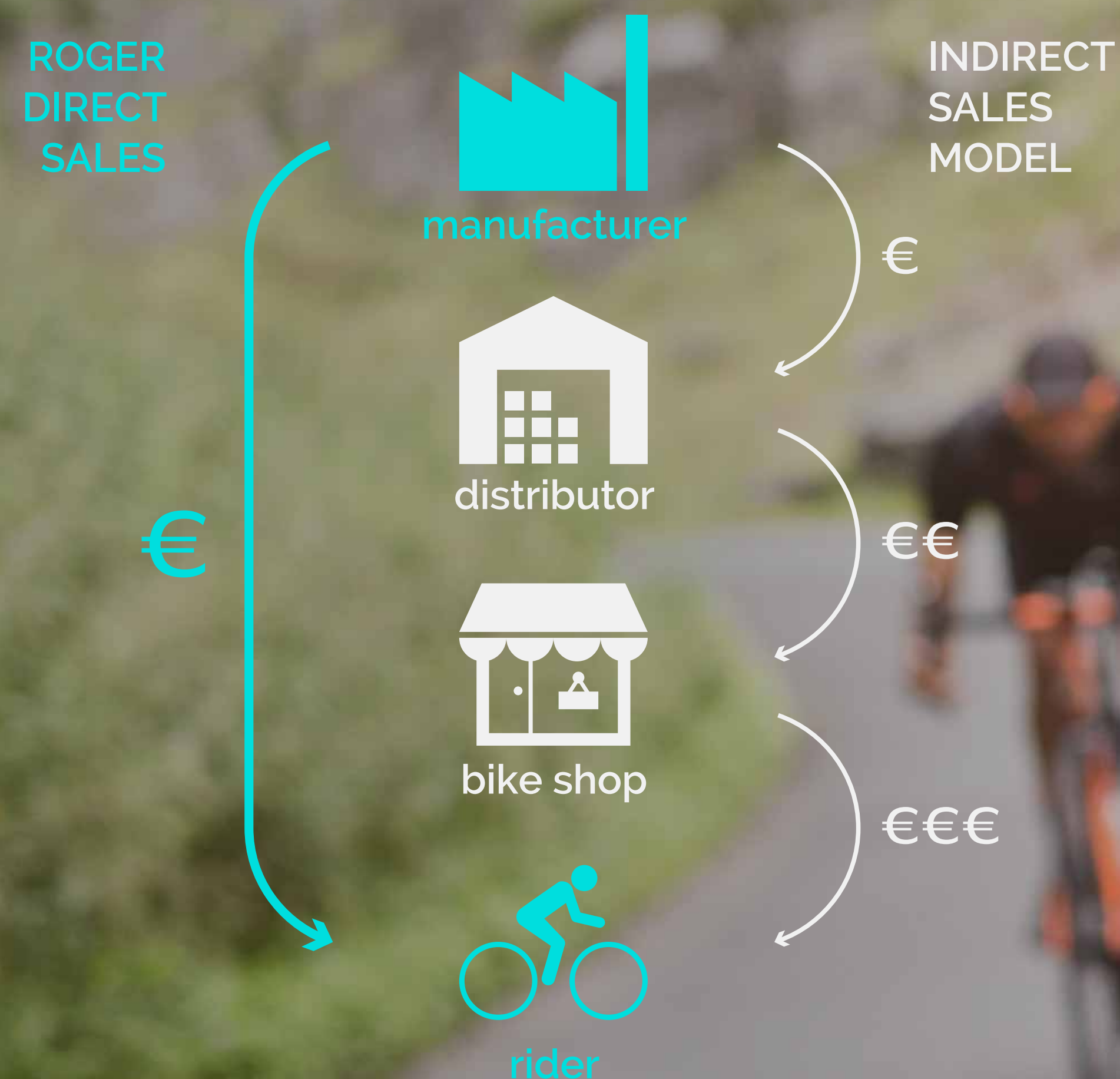

This allows us to build that dream bike for you at the lowest price possible.



# Roger's Philosophy

Roger wants your dream bike to become reality.

Therefore we give you a guarantee of 3 years on the frame set and 2 years on paint.

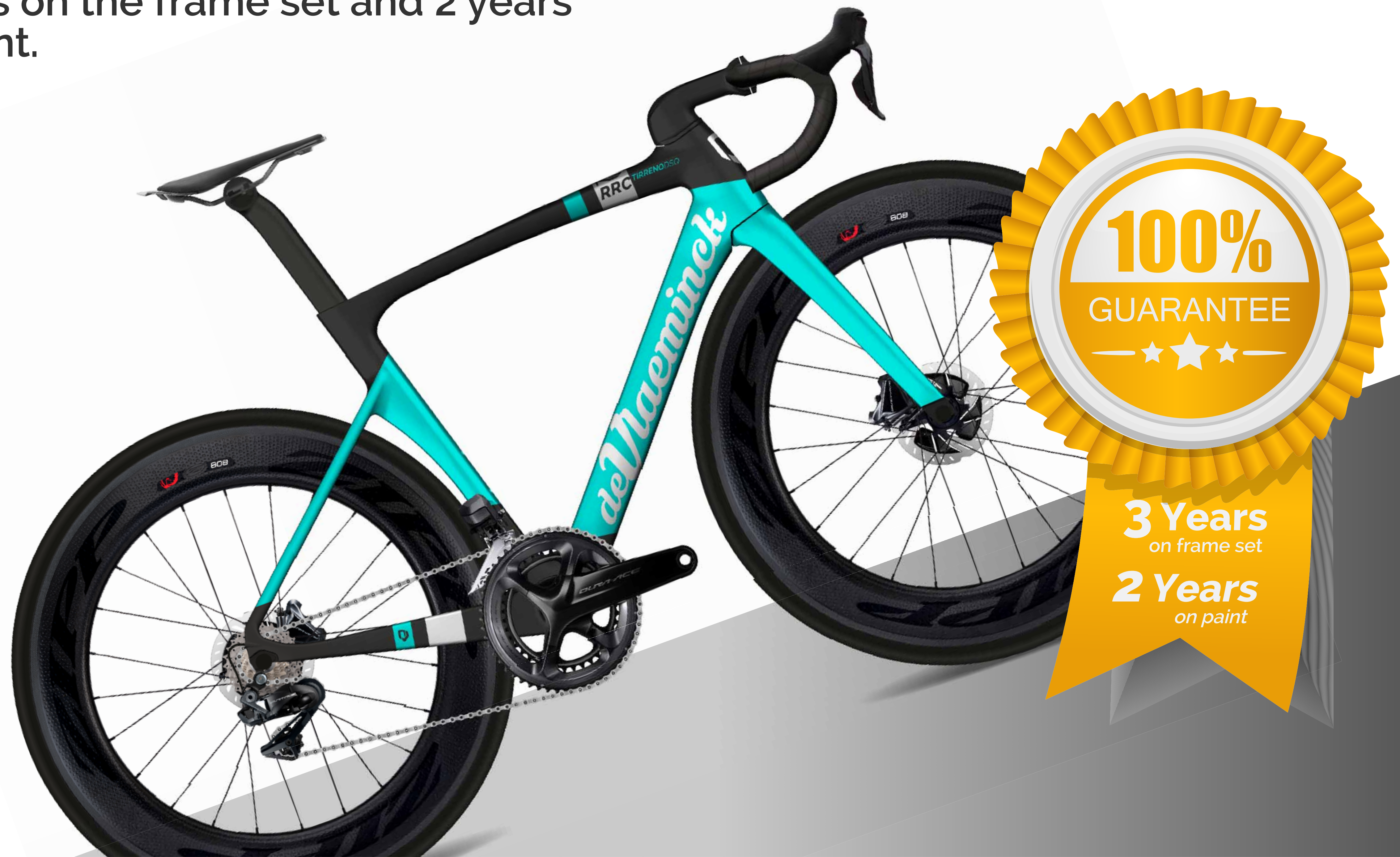



# Roger's Philosophy

Roger wants your dream bike to become reality.

Therefore we paint the bike according to your wishes.





# Roger's Philosophy

By choosing a frame set, a design and the colors, you are one step closer to creating your dream bike

We have some nice designs to choose from.

Complete your design with your favorite colors. Roger has a practically infinite palette of colors.



  
SVELTO

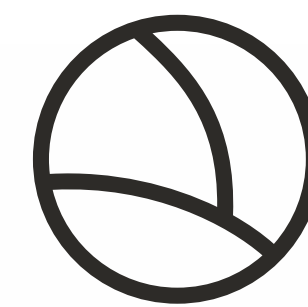

  
SVELTO  
Aqua/Black





# Roger's Philosophy



Roger wants your dream bike to become reality.

Therefore you are free in your choice of components.

Roger offers you a range of brands at different price levels. But say for instance, you already have a wheelset or you have seen your dream wheels online somewhere, you can order your Roger bike without wheels.

You might even want to switch your groupset over to a new Roger frame.

No problem, we are flexible.



# #buildyourroger

Roger offers you a selection of build levels to get you started.



Feel free to switch components to meet your preferences.

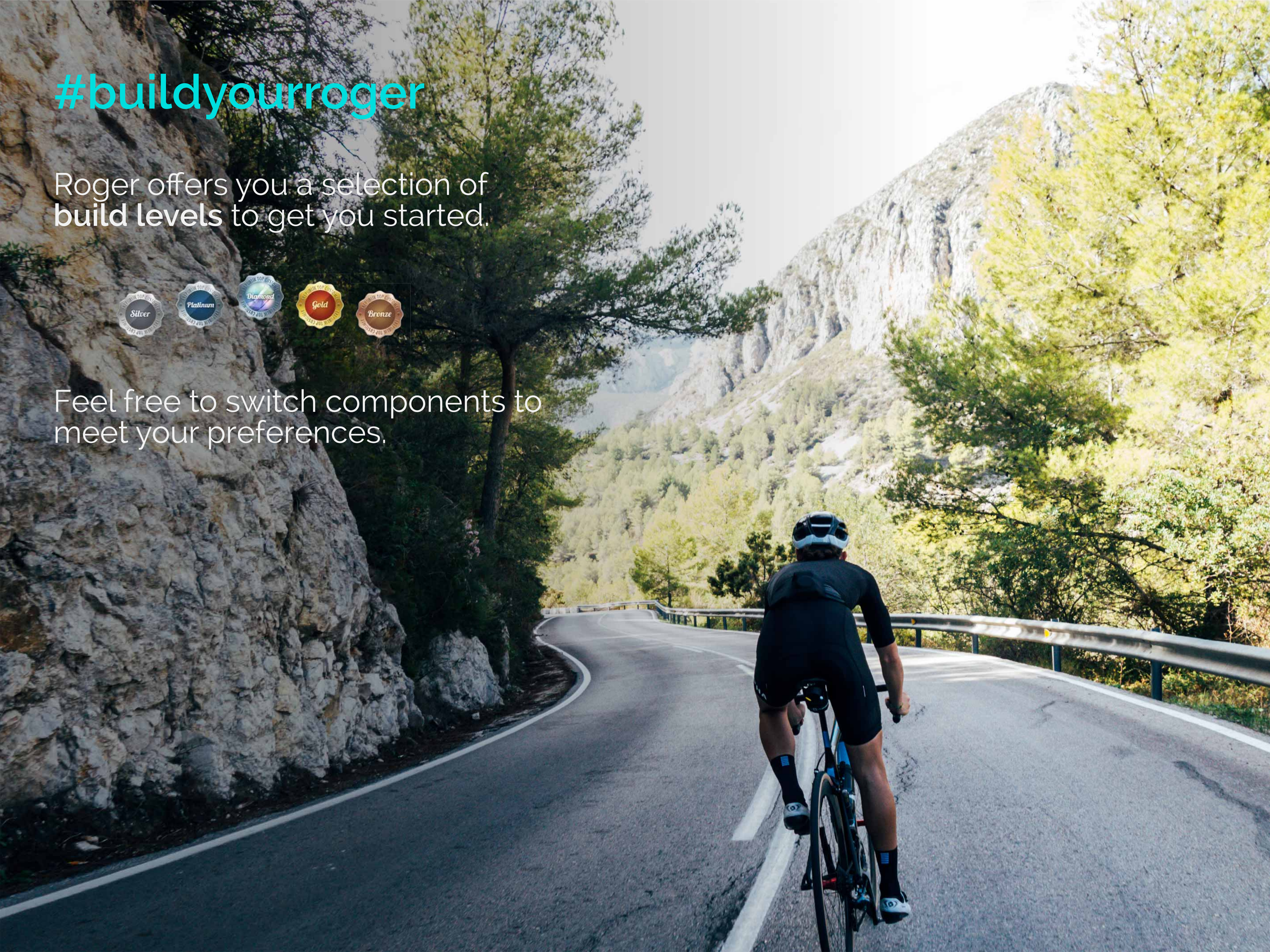





FRAMES





# Frame Technology

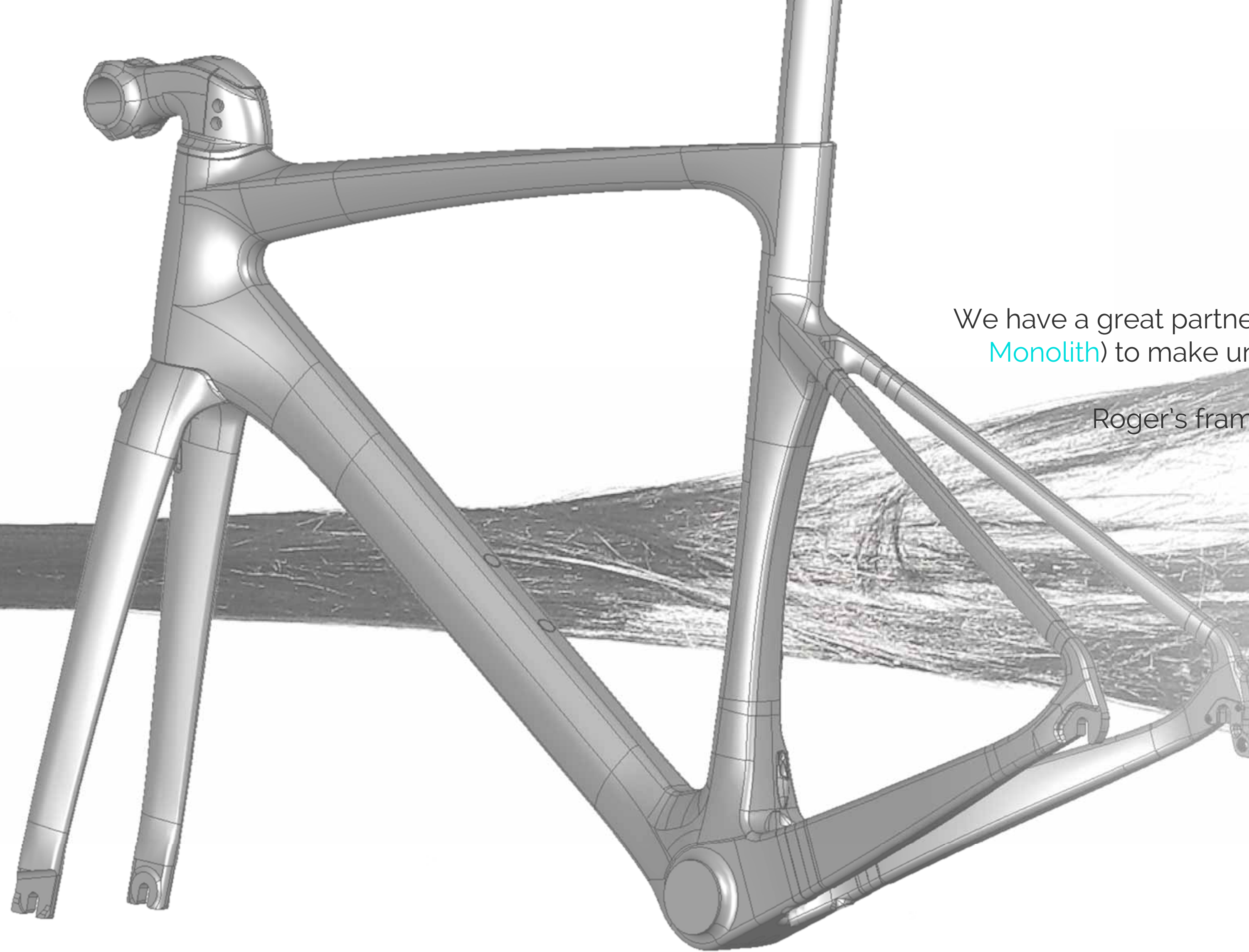

We have a great partner in China with tons of experience and proprietary technology (see [Monolith](#)) to make unique carbon frames. They are reliable and have a great STW ratio.

Roger's frames meet the highest standards. We go **20% over ISO4210**, which is the new and improved international standard for bicycle safety.



Our frames are primarily made from T700 and T1000 prepregs, laid over [EPS molds](#), resulting in a nice blend of stiffness and compliance at a competitive weight.

## EPS molding

To compress the carbon against the inside of the mold, we use EPS (Expandable PolyStyrene) sections.

These sections are molded to represent the exact shape of the inside of the frame and fork.

Then they are wrapped with sheets of preregs and placed inside the mold.

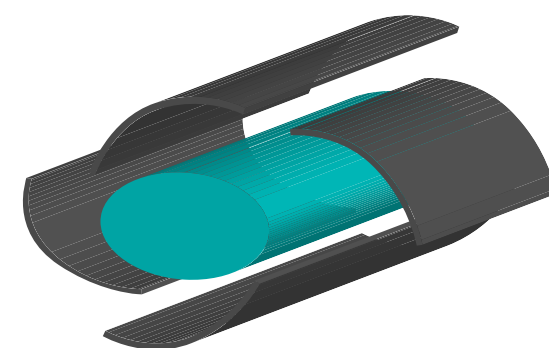

When the mold is heated, the EPS expands and presses the carbon sheets against the mold, creating a smooth and voidless wall. This ensures the best possible construction in terms of weight, stiffness and strength.

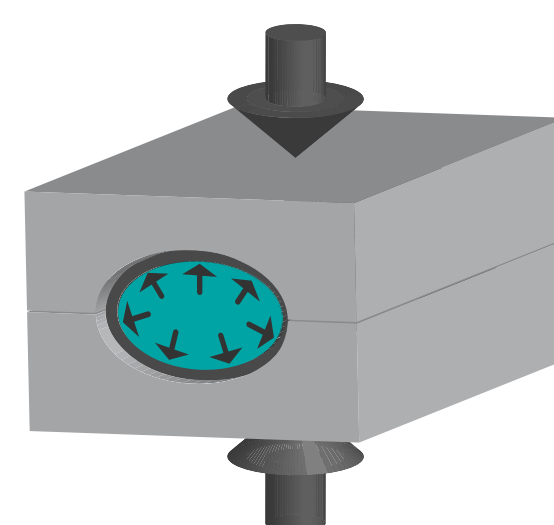
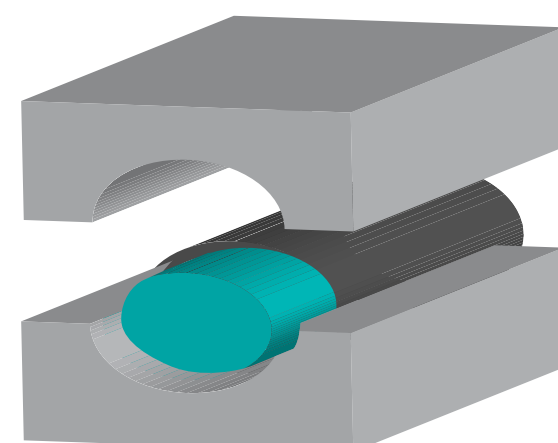
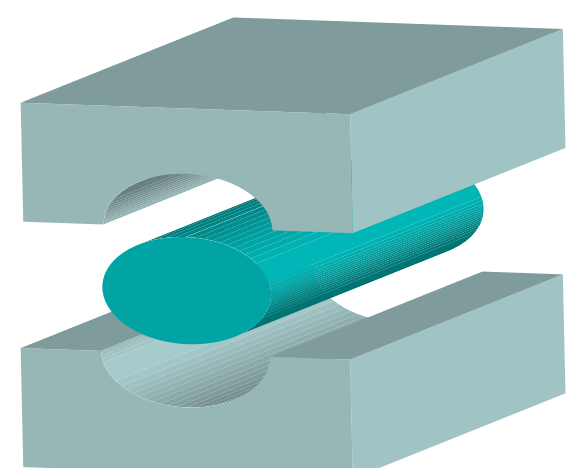

## MONOLITH - true monocoque

Monolith molding is proprietary method of molding a frame in one session....true monocoque!

Usually a frame is divided into a few main sections (like front triangle, separate seat and chain stays) which are bonded together after molding.

With Monolith, the entire frame is molded as a one-piece product. This allows carbon sheets to run across the 'classic' transitions without interruption. These critical transitions are now optimized for stiffness and strength, without the penalty of extra weight.

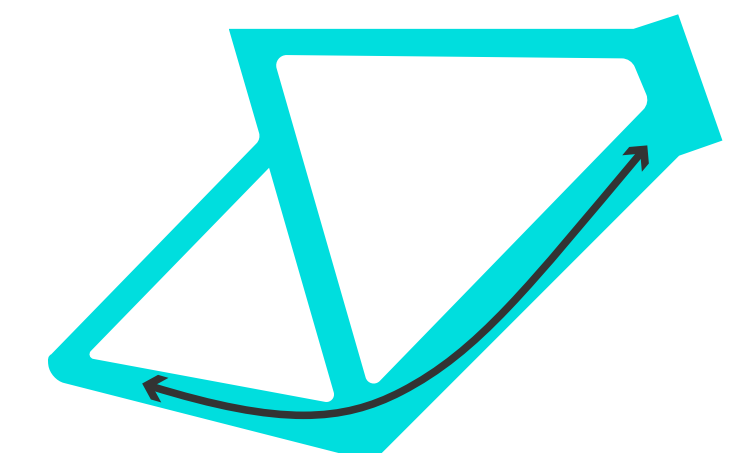
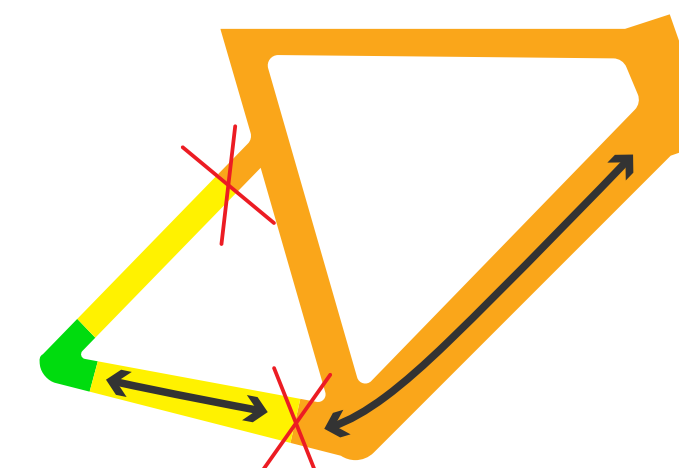



# TIRRENO DSQ



## Tech

EPS High Modulus  
T700 / T1000

## Aero

Optimized aerofoil shaping.  
Integrated fork crown.  
Hidden seat post clamp.  
Semi-covered rear wheel.

## Integration

With an integrated aero cockpit  
and concealed cable routing,  
this bike will take you to the  
next level.

## Disc

100% reliable and predictable  
braking, in all conditions.

## Specs

COCKPIT	SEAT POST	HEADSET	TIRES	FRONT MECH	BRAKES	BOTTOM BRACKET	FRAME SIZES	WEIGHT	PRICE
Aero carbon bar 400 / 420 / 440 Aero alloy stem 80 / 95 / 110 / 125	Aero carbon, integrated	1.5" - 1.5"	700c - up to 28mm	Braze-on	Disc Flat Mount	BB86	XS, S, M, L, XL	1180g (size M)	€1685,- (incl. post, stem & bar)



# TIRRENO



## Tech

EPS High Modulus  
T700 / T1000

## Aero

Optimized aerofoil shaping.  
Integrated fork crown.  
Hidden seat post clamp.  
Semi-covered rear wheel.  
Rear brake under BB.

## Integration

With an integrated aero cockpit  
and concealed cable routing,  
this bike will take you to the  
next level.

## Direct Mount

Stiffer and more consistent  
braking.

## Specs

### COCKPIT

Aero carbon bar  
400 / 420 / 440  
Aero alloy stem  
80 / 95 / 110 / 125

### SEAT POST

Aero carbon,  
integrated

### HEADSET

1.5" - 1.5"

### TIRES

700c - up to  
28mm

### FRONT MECH

Braze-on

### BRAKES

Caliper Direct  
Mount

**BOTTOM  
BRACKET**  
BB86

### FRAME SIZES

XS, S, M, L, XL

### WEIGHT

1150g (size M)

### PRICE

€1575,-  
(incl. post, stem  
& bar)



# SAN REMO



## Tech

EPS SL High Modulus  
**MONOLITH** one-piece  
T700 / T1000

## Lightweight

Incredibly responsive, yet superlight and reliable. This is **Monolith EPS** technology working for you.

## Stiff

**Monolith** allows entire carbon sheets to run from front to rear, transferring your power without delay or flex.

## BB386

Adding stiffness with the over-sized bracket area.

## Specs

**SEAT POST**  
Carbon SL

**HEADSET**  
1.125" - 1.5"

**TIRES**  
700c - up to  
28mm

**FRONT MECH**  
Braze-on

**BRAKES**  
Cantilever Road

**BOTTOM  
BRACKET**  
BB386

**FRAME SIZES**  
45, 48, 51, 54,  
57, 60

**WEIGHT**  
810g (size M)

**PRICE**  
€1695,-  
(incl. post)



# GEOMETRY

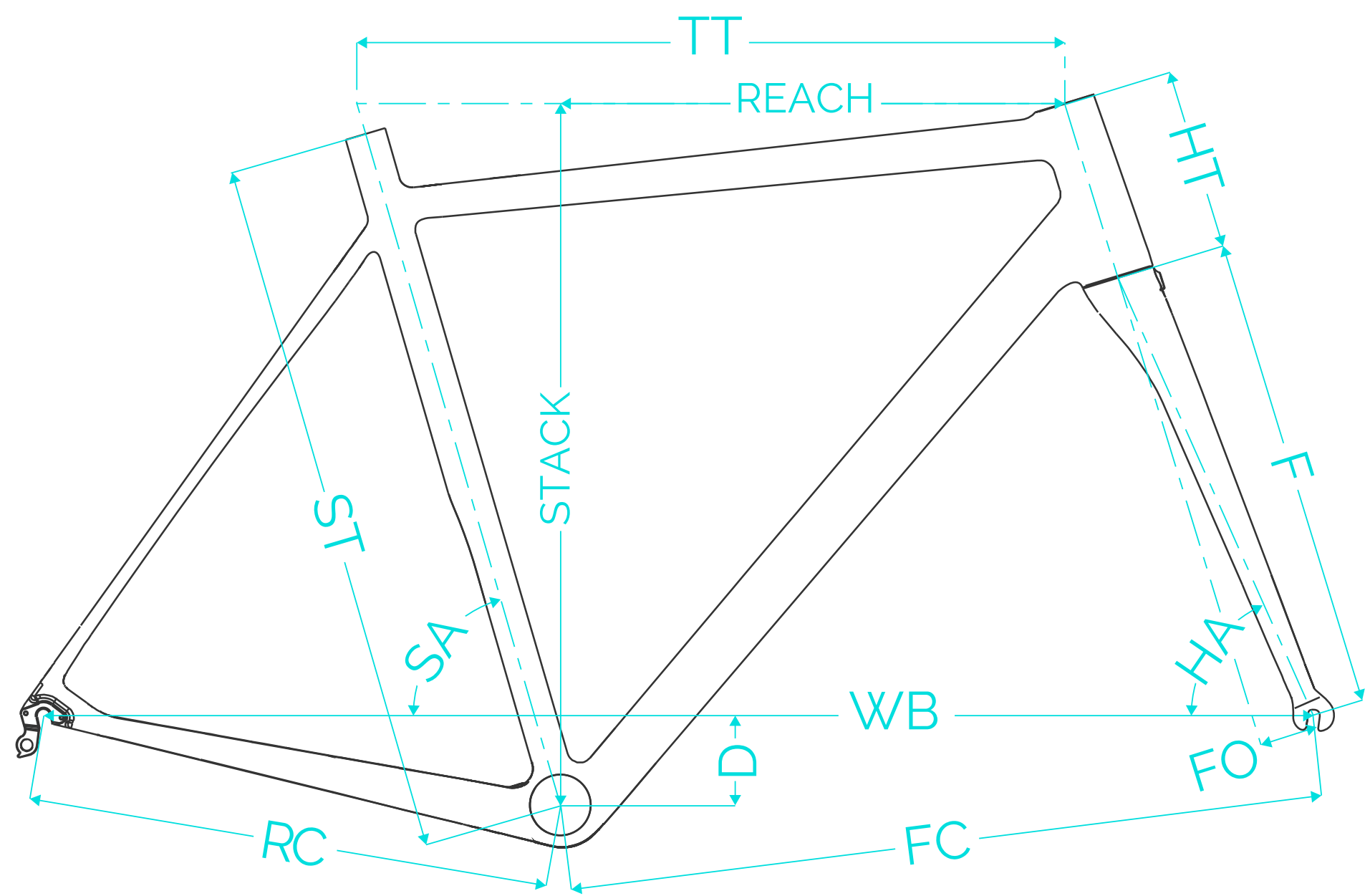
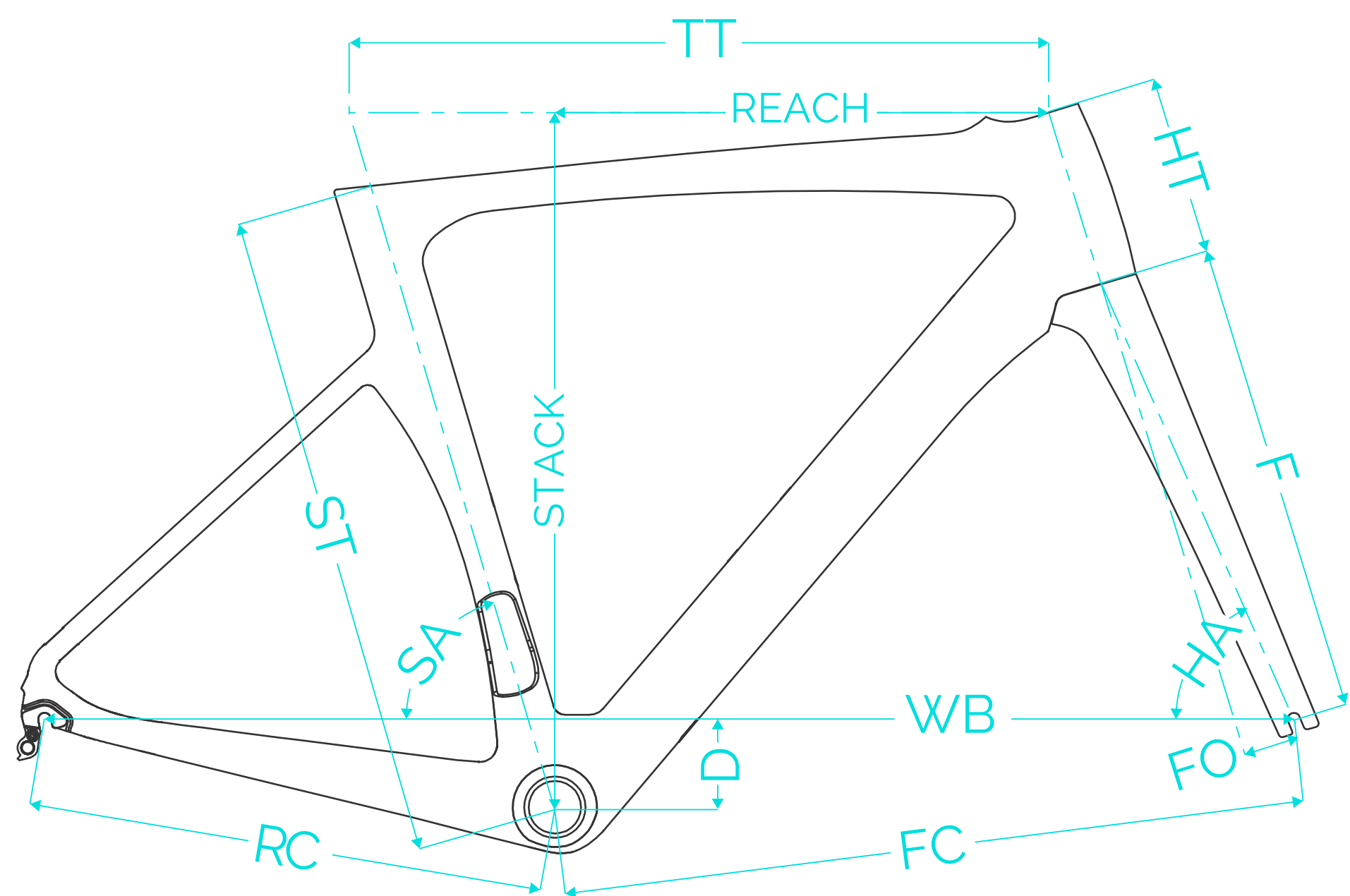

## Tirreno / Tirreno DSQ

SIZE	ST	TT	SA	HT	HA	F	FO	WB	FC	RC	D	REACH	STACK
XS	467	515	75°	105	72°	368	45	968	573	405	69	380	506
S	487	536	74°	120	73°	368	45	970	575	405	69	385	524
M	507	547	73.5°	140	73°	368	45	975	580	405	69	386	543
L	527	565	73.25°	160	73.5°	368	45	988	593	405	69	395	564
XL	547	582	73°	190	73.5°	368	45	1002	607	405	69	401	593

## San Remo

SIZE	ST	TT	SA	HT	HA	F	FO	WB	FC	RC	D	REACH	STACK
50	500	522	74.4°	115	72°	368	45	968	574	405	72	377	532
52	520	534	74.1°	125	72.6°	368	45	974	579	405	69	384	527
54	540	547	73.8°	140	72.9°	368	45	981	586	405	69	389	542
56	560	561	73.6°	155	73°	368	45	990	595	405	69	395	570
58	580	575	73.2°	175	73.2°	368	45	1000	605	405	69	401	577





[www.rogerdevlaeminck.be](http://www.rogerdevlaeminck.be)



#buildyourroger



BuildYourRoger